



situation plant 1/1000

Faced with the challenge of building a pavilion dedicated to the ceramics in the Biennial of Architecture of Venice, and surrounded by several buildings of different styles, we propose an abstract work which develops its main programme underground.

Different from the unity of the adjacent pavilions and because of its central position, we bet on building a sequence of open elements for not closing the space and let a fluid connection between the square and the different pavilions.

On one hand, these boxes work as a piece of access and several services. On the other hand, they act as true traps which provide the room natural light.

The generated space among the boxes is thought to be a route of staying places, gardens and even to organize outside exhibitions.

By means of the stairs framed by both brick walls to get to an open, abstract and fluid space with natural light in which the brick is essential, painted in white, to make the most of the light.

The big skylights mark a spiral route and the display stands arrange in a way which creates a movement. At the same time, the high of the boxes varies searching for the eldest amount of light.

Finally, in the background, a little volume with a secondary access contains service spaces.

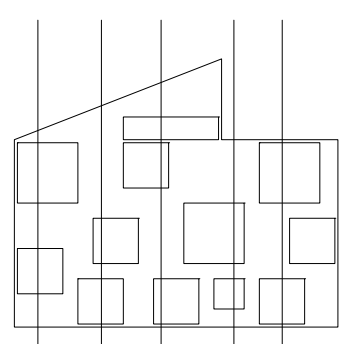
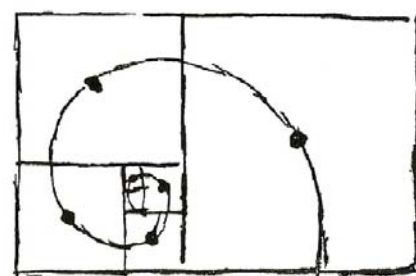

sections 1/100



ground floor 1/100

